

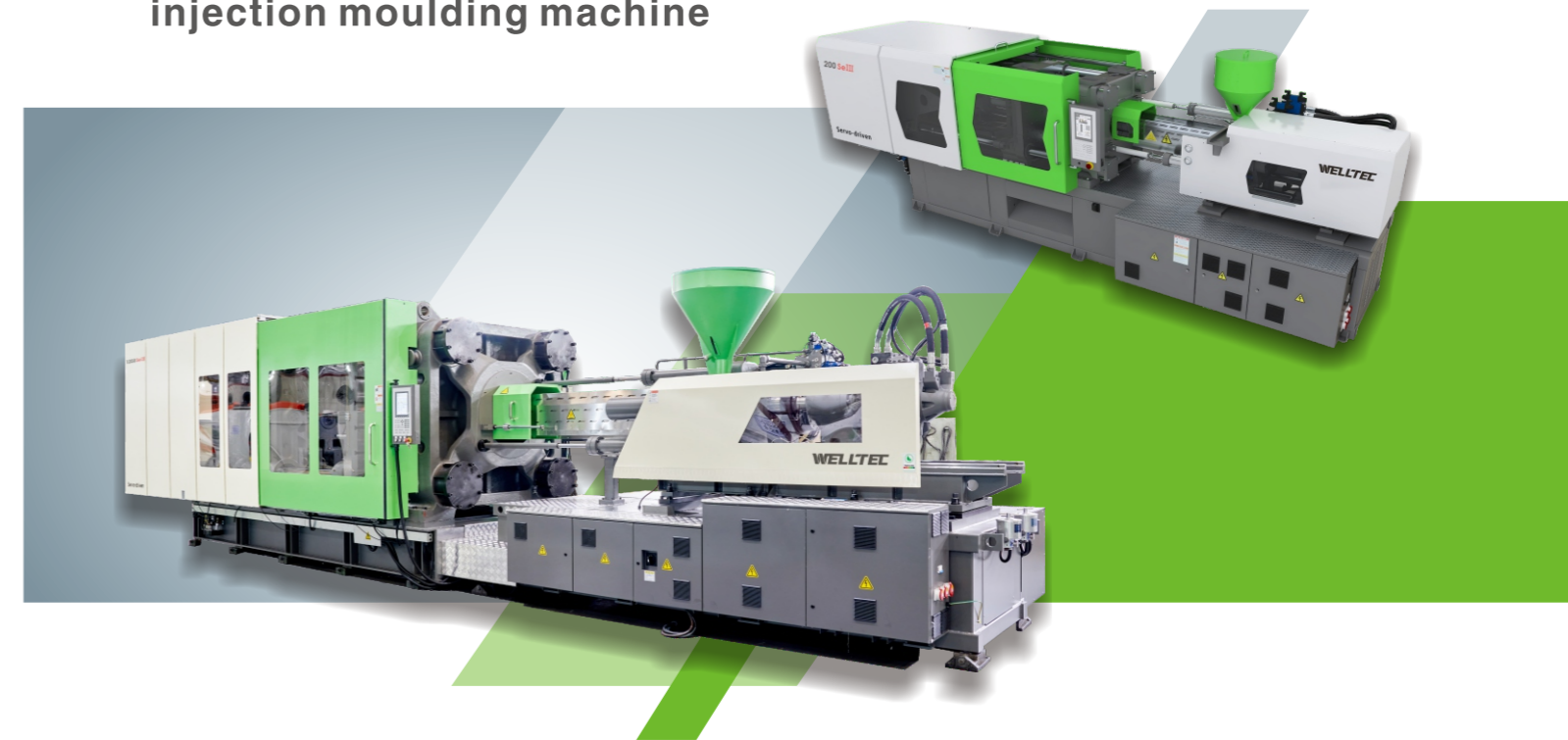

Sell series (60-2200Ton)

The benchmark for high-performance injection moulding machine





New generation upgrades



Opening stroke
increased by up to
15%



Ejector stroke
increased by up to
20%



Mould thickness
increased by up to
15%



Max. daylight
increased by up to
55%



Ejector force
increased by up to
40%

Upgraded components with SeIII

- Guide rail added for injection unit
- Mould height adjustment by gear for 90-160T
- Hopper sliding device for 90- 320T
- European style ejector
- Built-in oil cooler
- Fully enclosed injection unit

Features

- **30%** higher energy saving than using traditional variable pump
- Stable and smooth movement supported by AC servo motor
- Effective reduction of energy consumption due to reduced oil and cooling water attained by hydraulic system
- High performance European B&R control system

SeIII series (60-2200Ton)

The benchmark for high-performance injection moulding machine

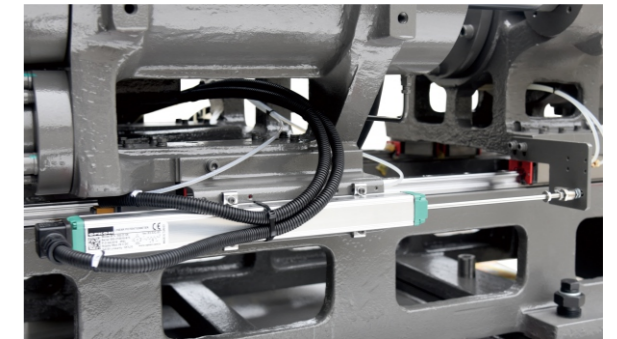
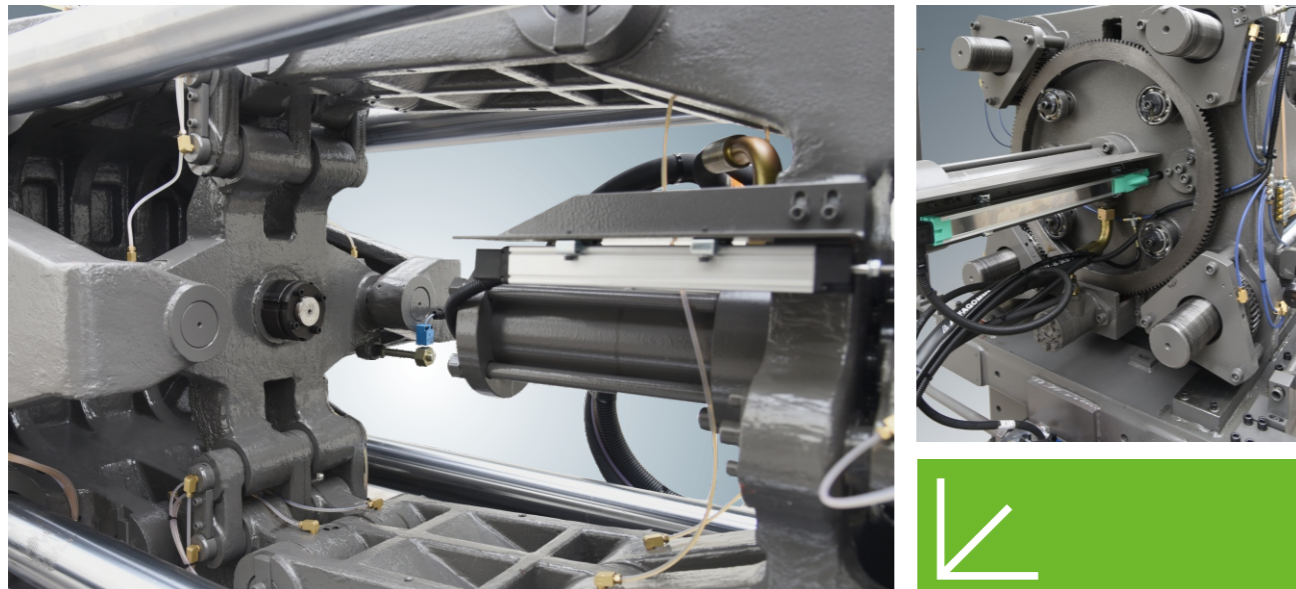

Injection Unit

- Newly optimised injection unit design to enable various production needs
- Diagonally located cylinders to facilitate better stress distribution
- Linear guide rail significantly reduces mechanical wear and tear (90-850SeIII)

Clamping Unit

- Extra durability achieved through optimised clamping structure
- Optimised platen design to disperse stress
- Accurate pause and smooth and speedy movement supported by strengthened toggle
- High pressure lubrication system adopted in clamping unit to support machine protection during high speed production
- The toggle's special heat-treated steel case enables higher wear resistance
- High-rigidity frame supports smooth movement

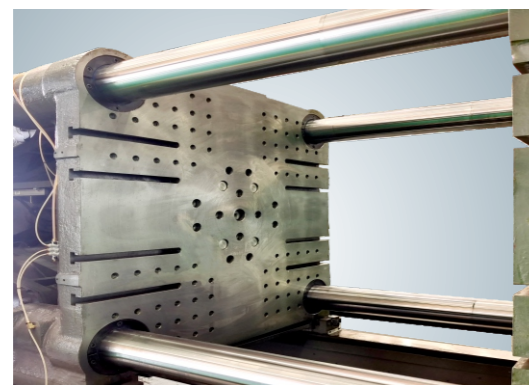
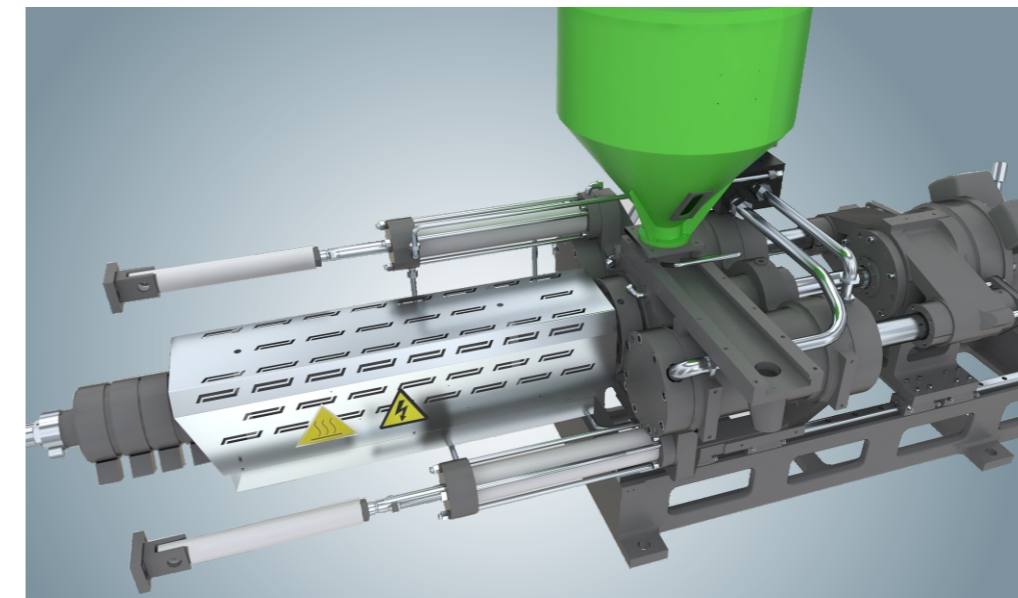

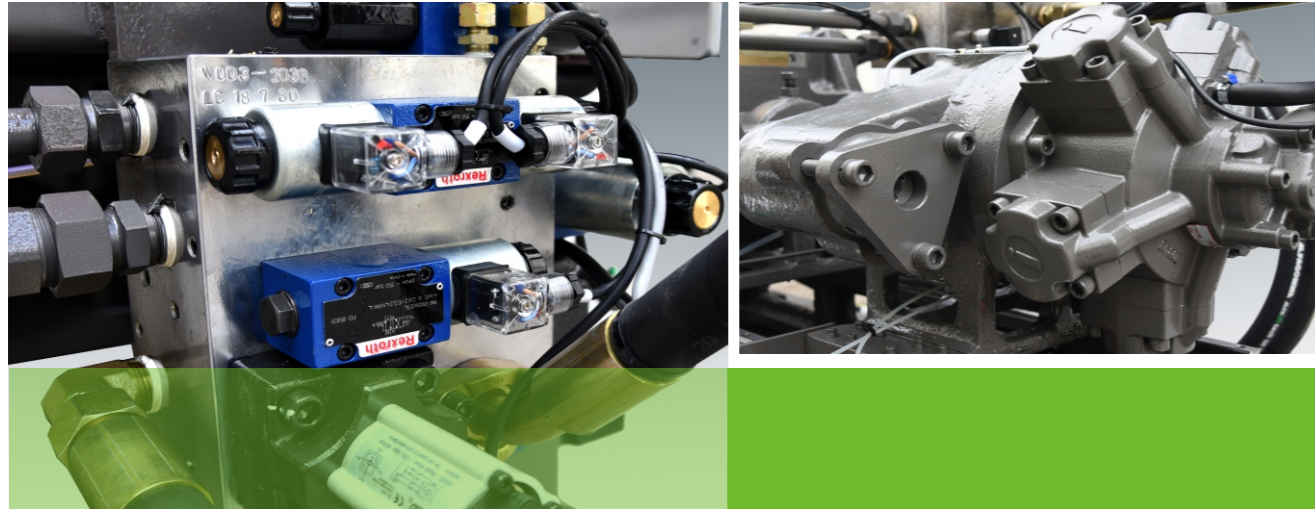

Hydraulic System

- Efficient and stable servo hydraulic system
- Minimised energy loss attained through the advanced hydraulic pipeline design
- Low-noise
- Advanced servo pump improves machine performance

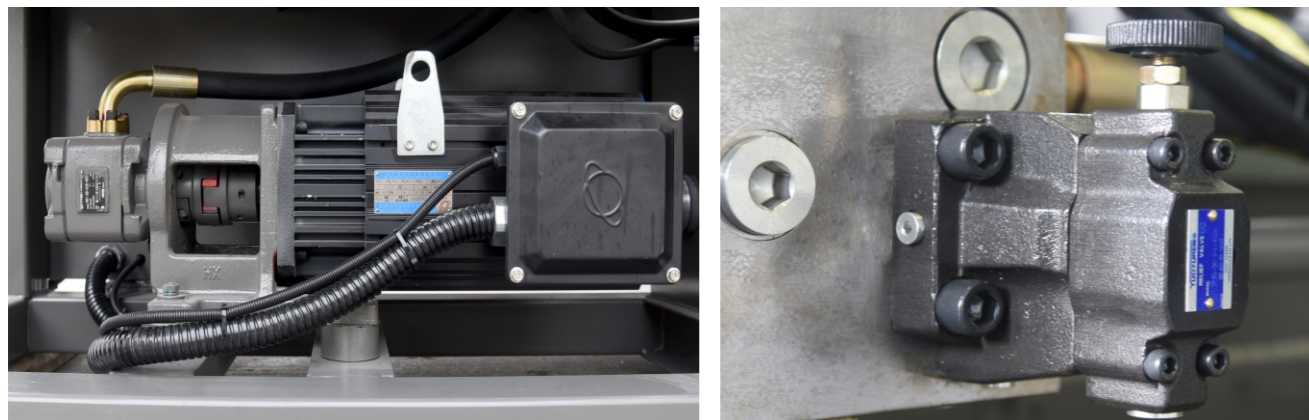

Software & Functions



S09 smart control system

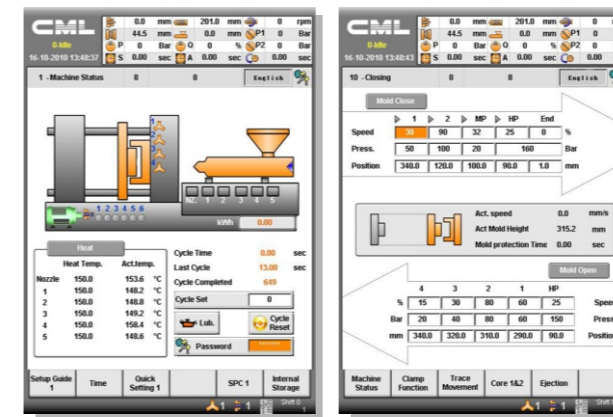

- High performance European B&R control system
- 10.4" TFT colour LCD display
- Users can identify the changes of parameter and sources of the changes
- Parameter data statistics for quality control
- Auto control of temperature by PID
- Mould parameter can be stored in USB devices and used in another injection moulding machine
- Remote motoring of parameter and operation sequence by MODEM or Ethernet
- Multi-language selection

iSee Facilitates real-time monitoring, remote diagnosis and smart factory management (optional)

Standard and Optional Features

standard ● optional ○

Injection Unit

Nitrided screw	●
Movable hopper (90-320T)	●
Fixed hopper (380-660T)	●
Barrel protective cover	●
Injection / holding pressure/ plasticising setting	●
Screw cold- start prevention system	●
Automatic heat preservation and heating device	●
Anti-drooling function	●
Automatic purging system	●
Automatic injection failure detection	●
Purge guard	●
Reduced/ enlarged ONE STEP injection unit	○
Bimetallic Screw and Barrel	○
Extended nozzle	○
Spring-loaded nozzle	○
Hydraulic/ Pneumatic shut-off nozzle	○
Material loading platform	○
Electric plasticising	○
Linear transducer for injection carriage	○
Wide varieties of screw and barrels for engineering, recycled and glass fiber composed resins	○

Clamping Unit

High pressure centralised lubrication system	●
Hydraulic and electrical safety device	●
Multi-function ejector control	●
Fast mould-close function (160- 2200 T)	●
Auto mould height adjustment	●
Mould ejector backward device	●
Increase mould thickness range	○
SPI mounting hole platens	○
Quick mould change system (T-slot necessary)	○
Increase ejector force	○
Increase ejector stroke	○
Retractable tie bar	○
Mould hanger	○

Hydraulic Unit

Closed-loop servo control of pressure and flow rate	●
Adjustable back pressure control	●
Y- strainer for water cooling	●
Special servo motor and servo drive	●
High-performance servo pump	●
Core pulling (fixed / movable platen)	○
Unscrew device with motor	○

Oil level sensor and alarm	○
Plasticising during mould opening	○
Ejector on fly	○
Injection accumulator	○
Proportional direction valves for clamping	○
Hydraulic / Pneumatic sequential injection	○
Enlarged motor & pump (hydraulic circuit)	○
Solenoid valve for oil cooler to control water flow	○
Extra air blast	○

Control Unit and Electric Components

TFT colour LCD display	●
B&R control system	●
Multi-lingual display	●
PID temperature control	●
Heating control contactor	●
Mould data locking function	●
Speed limitation device	●
Fault alarm	●
SPC analysis	●
Robot interface	●
Individual power plug of different voltages	○
Voltage stabiliser	○
Power meter	○
Solid state relays	○
Hot runner control	○
Ceramic / Infrared heater bands	○
Robot interface (EUROMAP 12/ 67)	○
Lighting inside electric cabinet	○
Electric unscrew (Device interface)	○
Air conditioner for electric cabinet	○
Circuits check for heater bands	○
iSee software - intelligent management system	○

Others

Water flow regulator	○
Widened guard door	○
Full guard cover (for top of tail platen)	○
Sliding top cover	○
Electric automatic guard door	○
Non-standard machine colour	○

SeIII series (60-2200Ton)

The benchmark for high-performance injection moulding machine



Specifications

ITEM	UNIT	60SeIII		90SeIII		130SeIII		160SeIII			
		600-180	900-312	1300-433	1600-629						
Injection unit											
Screw diameter	mm	25	30	35	40	35	40	45	40	45	50
Theoretical shot volume	cc	69	124	168	220	192	251	318	283	358	442
Shot weight (PS)	g	63	113	153	200	175	229	289	257	326	402
Shot weight (PS)	oz	2.2	4.0	5.4	7.1	6.2	8.1	10.2	9.1	11.5	14.2
Length/diameter ratio	L/D	22	24	20.6	18	23.4	20.5	18.2	22.5	20	18
Injection pressure	MPa	261	254	186	143	225	172	136	223	176	142
Injection rate	cm ³ /sec	78	83	113	147	93	122	154	147	187	230
Injection stroke	mm	140	175	175	200	200	225	225	225	225	225
Max. screw speed	rpm	300	237	237	205	205	274	274	274	274	274
Plasticising capacity (PS)	g/s	7.4	11.2	12.4	18.2	11.9	16.2	20.0	23.2	30.0	33.6
Injection unit force	Ton	3.4	5.7	5.7	5.7	5.7	5.7	5.7	5.7	5.7	5.7
Carriage stroke	mm	255	230	230	300	300	320	320	320	320	320
Clamping unit											
Clamping force	Ton	60	90	130	160	130	160	160	160	160	160
Max. daylight	mm	740	740	880	1000	880	1000	1000	1000	1000	1000
Clamping stroke	mm	360	360	430	480	430	480	480	480	480	480
Distance btwn. tie bars	mm	360x360	360x360	410x410	470x470	410x410	470x470	470x470	470x470	470x470	470x470
Min. mould dimension	mm	250x250	250x250	280x280	320x320	280x280	320x320	320x320	320x320	320x320	320x320
Mould thickness range	mm	120-380	120-380	145-450	150-520	145-450	150-520	150-520	150-520	150-520	150-520
Ejector force	Ton	4.1	4.1	4.1	7.7	4.1	7.7	7.7	7.7	7.7	7.7
Ejector stroke	mm	100	100	120	160	100	160	160	160	160	160
No. of ejector pins	unit	5	5	5	5	5	5	5	5	5	5
Power unit											
Max. motor power	kW	13.4	13.4	13.4	16.4	13.4	16.4	16.4	16.4	16.4	16.4
System pressure	MPa	17.5	17.5	17.5	17.5	17.5	17.5	17.5	17.5	17.5	17.5
Hydraulic pump capacity	L/min	72	72	72	112.5	72	112.5	112.5	112.5	112.5	112.5
No. of heating zones	unit	3+1+1	3+1+1	3+1+1	4+1+1	3+1+1	4+1+1	4+1+1	4+1+1	4+1+1	4+1+1
Heating power	kW	6.02	7.41	7.41	11.48	6.02	11.48	11.48	11.48	11.48	11.48
Total power	kW	20.42	21.81	21.81	28.88	20.42	28.88	28.88	28.88	28.88	28.88
Total current	A	27.9	29.8	29.8	39.5	27.9	39.5	39.5	39.5	39.5	39.5
General											
Machine weight	Ton	3.1	3.27	4.16	5.68	3.1	5.68	5.68	5.68	5.68	5.68
Oil filling capacity	L	200	200	200	280	200	280	280	280	280	280

We are always working on improvement and reserve the rights to change design and specifications without prior notice

Machine Dimensions

60SeIII-160SeIII

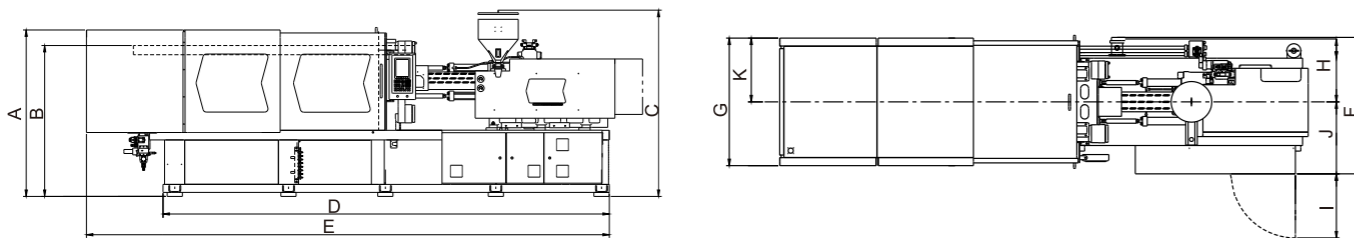

Model	A	B	C	D	E	F	G	H	I	J	K
60SeIII	1615	1400	1963	3560	4220	1054	1152	625	800	635	576
90SeIII	1615	1400	1963	3560	4220	1054	1152	625	800	635	576
130SeIII	1700	1486	1936	3878	4586	1104	1203	650	800	660	601.5
160SeIII	1758	1567	2050	4513	5215	1349	1302	717	800	789	651

Platen/Nozzle Dimensions

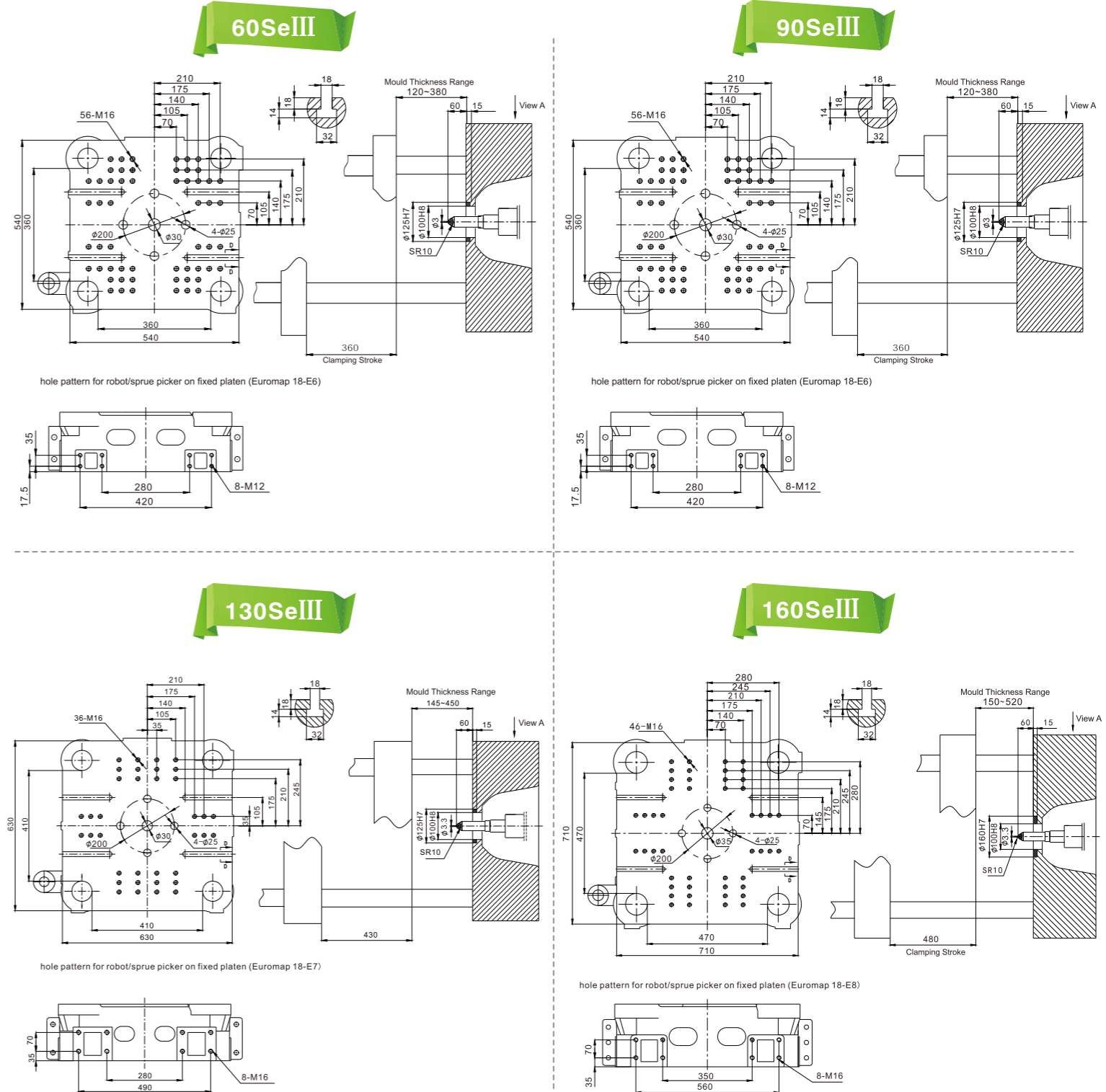

Remark: C-hopper height for reference only

SeIII series (60-2200Ton)

The benchmark for high-performance injection moulding machine



Specifications

ITEM	UNIT	200SeIII			260SeIII			320SeIII			400SeIII			
		2000-871			2600-1507			3200-1930			4000-2868			
Injection unit														
Screw diameter	mm	45	50	60	55	60	70	60	65	75	65	75	85	
Theoretical shot volume	cc	398	491	707	713	848	1155	919	1078	1436	1244	1657	2128	
Shot weight (PS)	g	362	447	643	649	772	1051	836	981	1307	1132	1508	1936	
Shot weight (PS)	oz	12.8	15.8	22.7	22.9	27.3	37.1	29.5	34.7	46.2	40.0	53.3	68.4	
Length/diameter ratio	L/D	24	21.6	18	22.9	21	18	22.5	20.8	18	23.9	20.7	18.3	
Injection pressure	MPa	219	177	123	211	178	131	210	179	134	231	173	135	
Injection rate	cm ³ /sec	150	185	266	237	282	384	306	359	477	348	463	595	
Injection stroke	mm	250			300			325			375			
Max. screw speed	rpm	185	215			175			224			196		
Plasticising capacity (PS)	g/s	22.5	28.0	34.2	39.6	58.3	52.9	49.3	55.4	77.9	66.8	89.7	116.0	
Injection unit force	Ton	9.1			9.1			9.1			12			
Carriage stroke	mm	350			400			400			435			
Clamping unit														
Clamping force	Ton	200			260			320			400			
Max. daylight	mm	1090			1210			1400			1530			
Clamping stroke	mm	540			600			700			780			
Distance btwn. tie bars	mm	535x535			580x580			680x680			740x740			
Min. mould dimension	mm	370x370			400x400			470x470			520x520			
Mould thickness range	mm	175-550			195-610			250-700			250-750			
Ejector force	Ton	9.9			11.1			11.1			16.6			
Ejector stroke	mm	170			195			200			210			
No. of ejector pins	unit	9			13			13			13			
Power unit														
Max. motor power	kW	16.4			26.7			40.9			50.7			
System pressure	MPa	17.5			17.5			17.5			17.5			
Hydraulic pump capacity	L/min	112.5			172			220			275			
No. of heating zones	unit	4+1+1			5+1			5+1			5+1			
Heating power	kW	14.25			18.9			22.15			28.99			
Total power	kW	31.65			46.6			64.05			80.69			
Total current	A	43.3			63.7			87.6			110.3			
General														
Machine weight	Ton	6.97			8.55			11.52			14.68			
Oil filling capacity	L	300			450			540			700			

We are always working on improvement and reserve the rights to change design and specifications without prior notice

Machine Dimensions

200SeIII-400SeIII

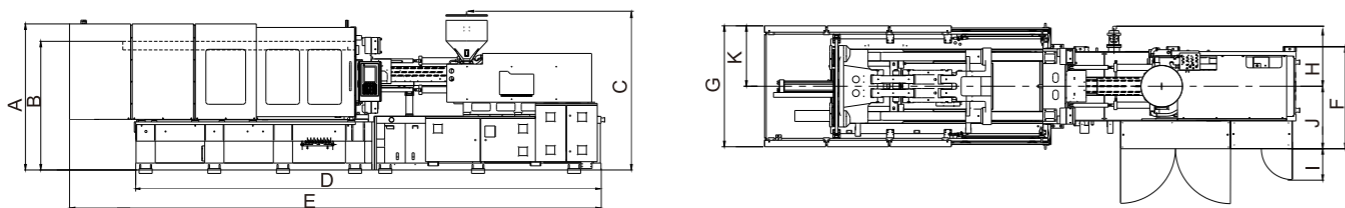

Model	A	B	C	D	E	F	G	H	I	J	K
200SeIII	1833	1645	2103	4753	5598	1364	1414	752	800	824	707
260SeIII	1961	1757	2185	5030	6072	1417	1462	810	800	852	731
320SeIII	2078	1884	2267	5575	6601	1517	1592	865	800	902	796
400SeIII	2176	1923	2284	6780	7744	1783	1760	874	800	909	880

Remark: C-hopper height for reference only

Platen/Nozzle Dimensions

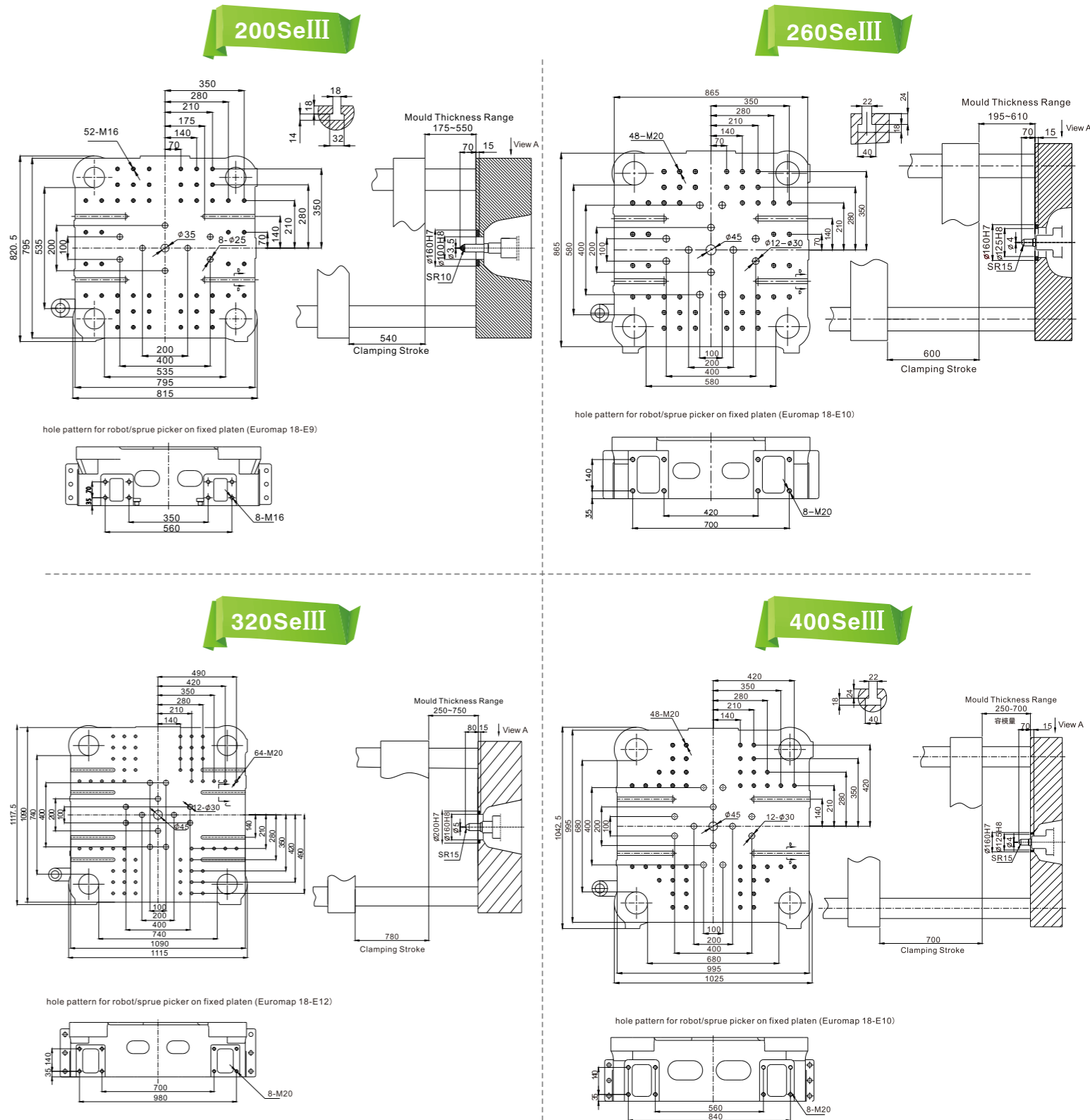

SeIII series (60-2200Ton)

The benchmark for high-performance injection moulding machine



Specifications

ITEM	UNIT	480SeIII			530SeIII			660SeIII		
		4800-3508			5300-4762			6600-4762		
Injection unit										
Screw diameter	mm	70	80	94	80	90	105	80	90	105
Theoretical shot volume	cc	1539	2011	2776	2212	2799	3810	2212	2799	3810
Shot weight (PS)	g	1401	1830	2526	1991	2519	3429	1991	2519	3429
Shot weight (PS)	oz	49.5	64.7	89.3	70.3	89.0	121.2	70.3	89.0	121.2
Length/diameter ratio	L/D	24.2	21.2	18	23.6	21	18	23.6	21	18
Injection pressure	MPa	228	174	126	215	170	125	215	170	125
Injection rate	cm ³ /sec	352	460	635	477	603	821	521	660	898
Injection stroke	mm		400		440				440	
Max. screw speed	rpm		170		148				161	
Plasticising capacity (PS)	g/s	72.7	94.3	131.3	80.4	97.5	147.5	87.9	106.7	161.3
Injection unit force	Ton		12		20.4				20.4	
Carriage stroke	mm		480		600				600	
Clamping unit										
Clamping force	Ton		480		530				660	
Max. daylight	mm		1600		1700				1830	
Clamping stroke	mm		780		850				910	
Distance btwn. tie bars	mm		820x800		840x830				920x920	
Min. mould dimension	mm		570X560		580X580				645x645	
Mould thickness range	mm		300-820		300-850				350-920	
Ejector force	Ton		16.6		16.6				16.6	
Ejector stroke	mm		240		240				290	
No. of ejector pins	unit		13		17				21	
Power unit										
Max. motor power	kW		50.7		71.2				67.1	
System pressure	MPa		17.5		17.5				17.5	
Hydraulic pump capacity	L/min		275		352				385	
No. of heating zones	unit		5+1		5+1				5+1	
Heating power	kW		35.04		35.73				35.73	
Total power	kW		86.74		107.93				103.83	
Total current	A		118.6		147.6				126.2	
General										
Machine weight	Ton		16.72		23				26	
Oil filling capacity	L		720		775				1140	

We are always working on improvement and reserve the rights to change design and specifications without prior notice

Machine Dimensions

480SeIII-660SeIII

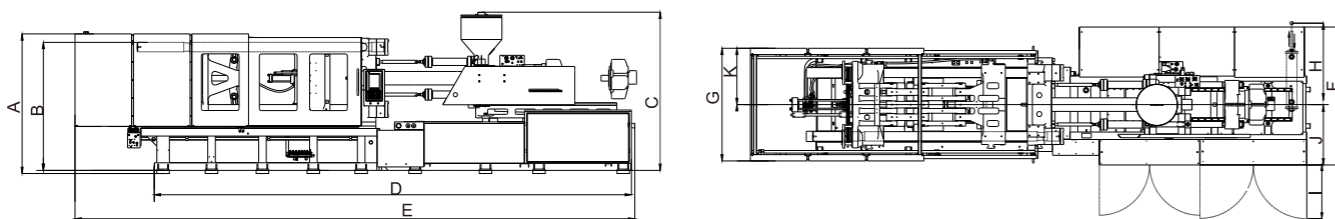

Model	A	B	C	D	E	F	G	H	I	J	K
480SeIII	2246	1985	2336	7006	8025	1797	1874	855	800	942	937
530SeIII	2244	2005	2495	7846	8995	1809	1900	865	800	945	950
660SeIII	2280	2125	2545	7783	9157	2193	1942	1420	850	960	971

Remark: C-hopper height for reference only

Platen/Nozzle Dimensions

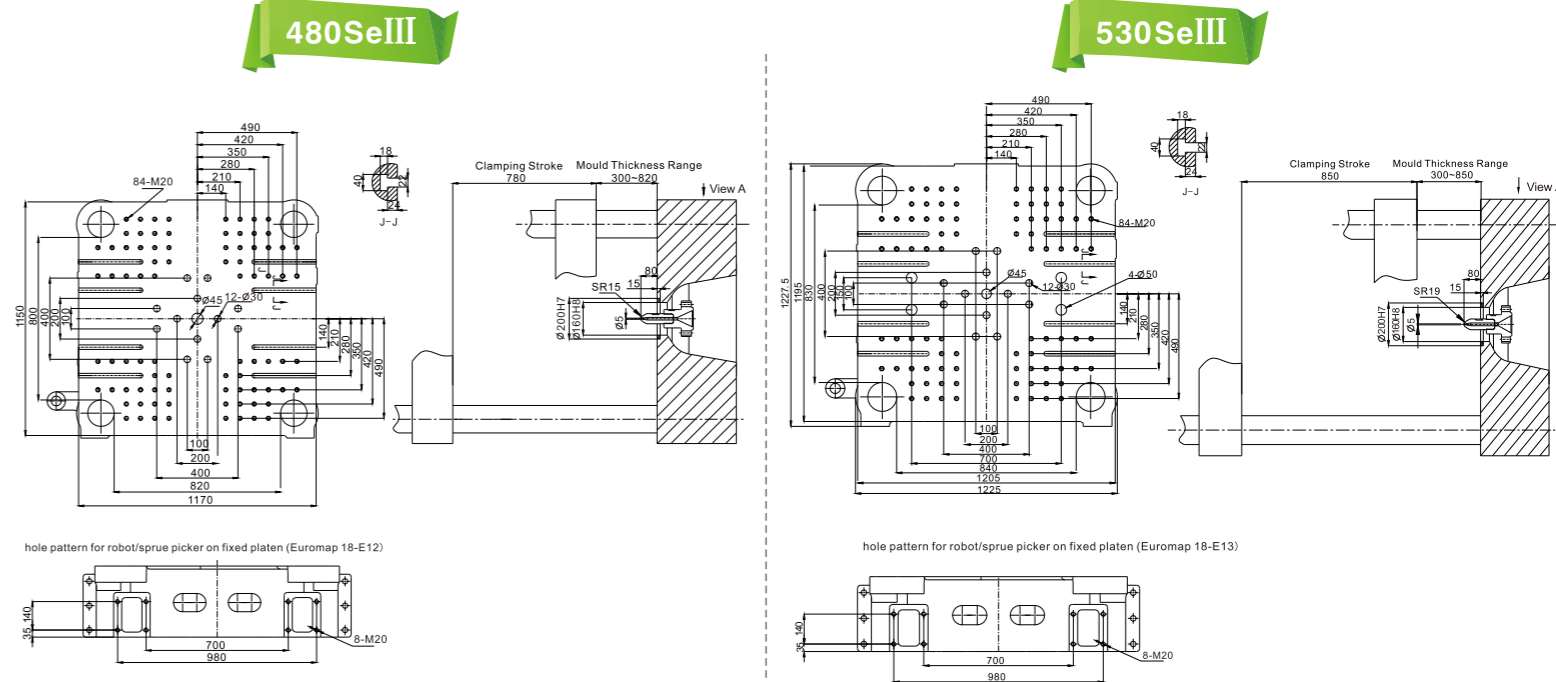

660SeIII

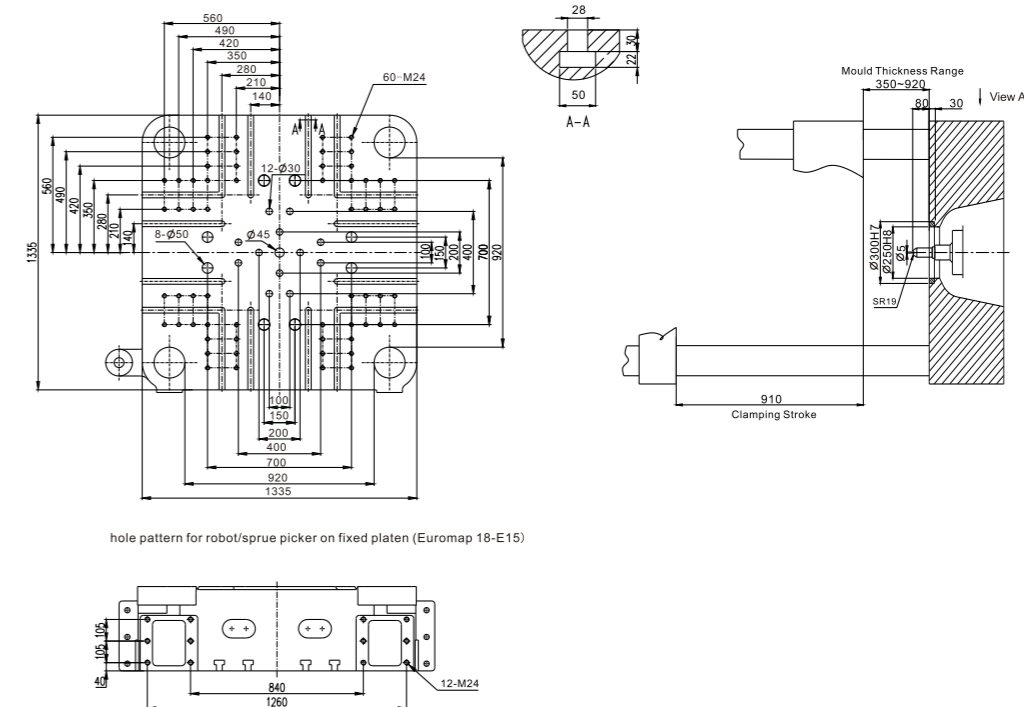

SeIII series (60-2200Ton)

The benchmark for high-performance injection moulding machine



Specifications

ITEM	UNIT	750SeIII			850SeIII			1000SeIII			1250SeIII		
		7500/6325			8500/6325			10000/8047			12500/12315		
Injection unit													
Screw diameter	mm	90	100	110	90	100	110	100	110	125	110	125	140
Theoretical shot volume	cc	2990	3691	4467	2990	3691	4467	3848	4657	6013	5293	6835	8574
Shot weight (PS)	g	2691	3322	4020	2691	3322	4020	3464	4191	5412	4764	6152	7717
Shot weight (PS)	oz	95	117	142	95	117	142	122	148	191	168	217	273
Length/diameter ratio	L/D	22.6	20.0	18.0	22.6	20.0	18.0	22.3	20.0	17.7	21.6	20.0	18.5
Injection pressure	MPa	212	171	142	212	171	142	209	173	134	233	180	144
Injection rate	cm ³ /sec	572	706	854	572	706	854	651	787	1017	650	839	1052
Plasticising capacity (PS)	g/s	73	100	121	73	100	121	93	118	154	106	151	184
Injection stroke	mm	470			470			490			557		
Max. screw speed	rpm	124			124			115			104		
Injection unit force	Ton	19.8			19.8			19.8			19.8		
Carriage stroke	mm	600			600			650			800		
Clamping unit													
Clamping force	Ton	750			850			1000			1250		
Max. daylight	mm	2050			2200			2300			2600		
Clamping stroke	mm	1025			1100			1150			1300		
Distance btwn. tie bars	mm	1000x1000			1060x1060			1100x1100			1250x1250		
Min. mould dimension	mm	700x700			740x740			780x780			875x875		
Mould thickness range	mm	350~1025			450~1100			450~1150			500~1300		
Ejector force	Ton	25			25			25			25		
Ejector stroke	mm	350			350			350			350		
No. of ejector pins	unit	21			21			21			21		
Power unit													
Max. motor power	kW	67.6			67.6			77.4			91.6		
System pressure	MPa	17			17			17			17		
Hydraulic pump capacity	L/min	440			440			495			550		
No. of heating zones	unit	5+1			5+1			5+1			5+1		
Heating power	kW	50			50			58			74		
Total power	kW	118.28			118.28			136.565			166.61		
Total current	A	143.8			143.8			166.0			202.5		
General													
Machine weight	Ton	39.1			43.0			52.0			68.2		
Oil filling capacity	L	1400			1400			1600			1600		

We are always working on improvement and reserve the rights to change design and specifications without prior notice

Machine Dimensions

750SeIII-1250SeIII

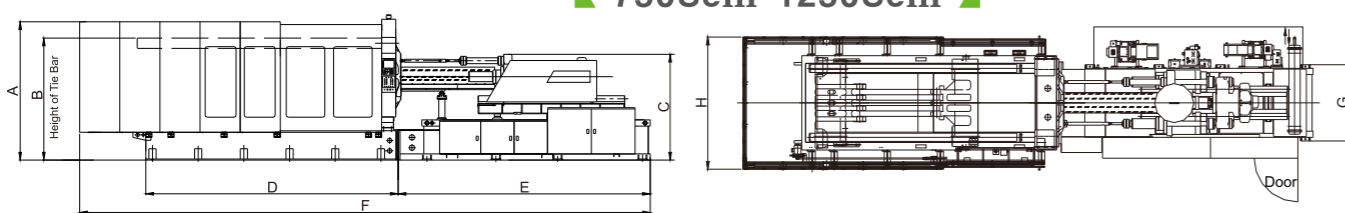

Model	A	B	C	D	E	F	G	H
750SeIII	2539	2227	2635	4318	4497	10192	1410	2295
850SeIII	2420	2300	2635	4668	4497	10514	1410	2340
1000SeIII	2687	2370	2717	4904	4900	11090	1482	2569
1250SeIII	2867	2530	2853	5485	5060	12149	1482	2812

Remark: C-hopper height for reference only

Platen/Nozzle Dimensions

750SeIII

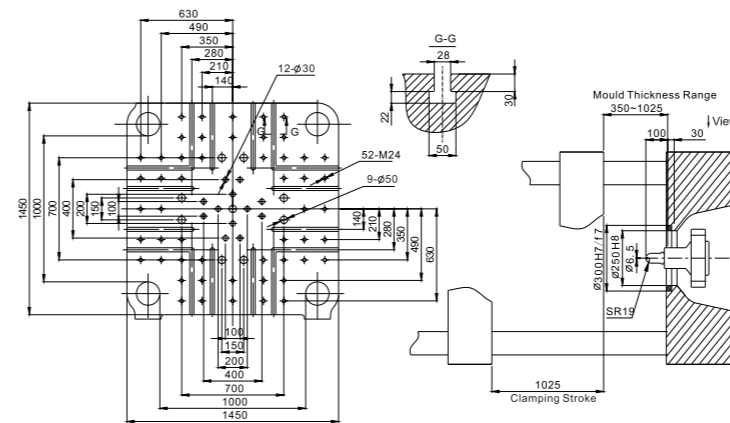

hole pattern for robot/sprue picker on fixed platen (Euromap 18-E15)

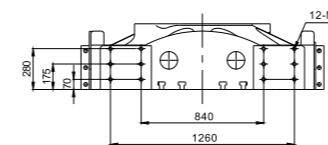

850SeIII

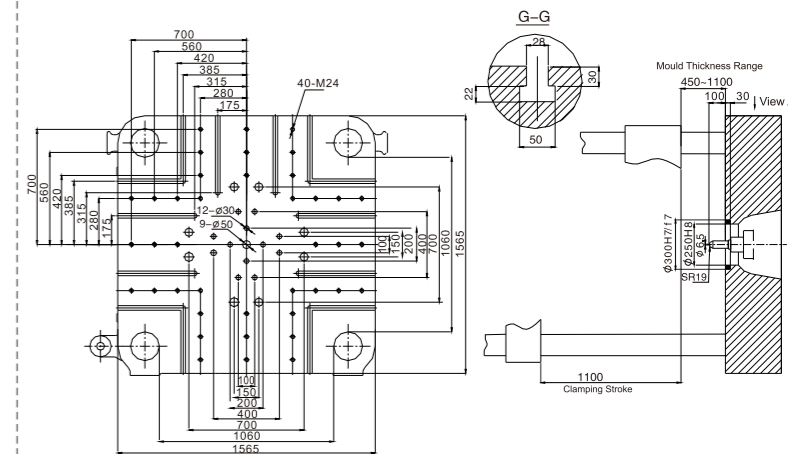

hole pattern for robot/sprue picker on fixed platen (Euromap 18-E13)

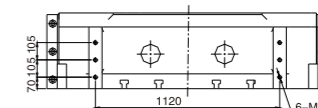

1000SeIII

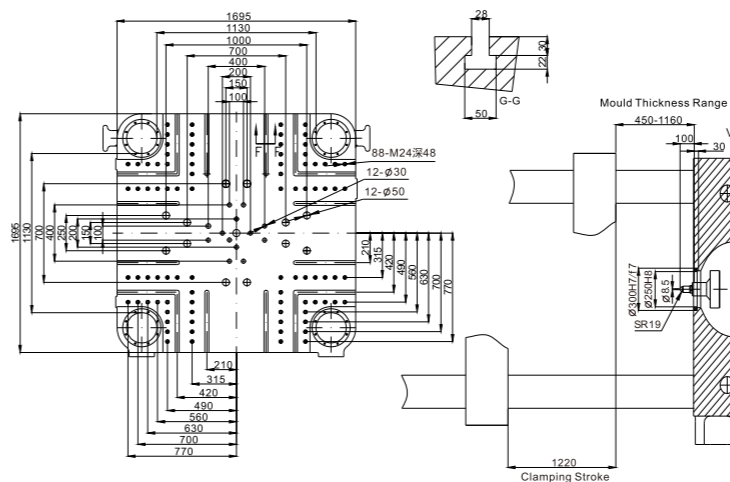

hole pattern for robot/sprue picker on fixed platen (Euromap 18-E13)

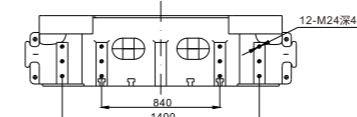

1250SeIII

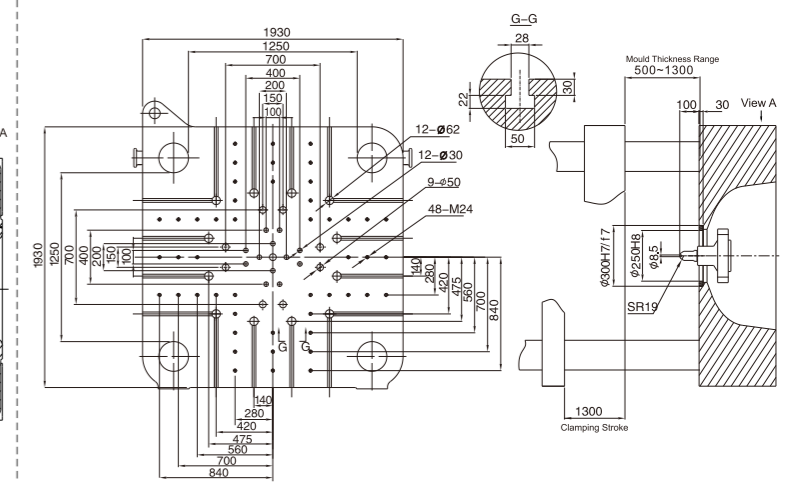

hole pattern for robot/sprue picker on fixed platen

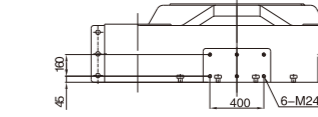

SeIII series (60-2200Ton)

The benchmark for high-performance injection moulding machine



Specifications

ITEM	UNIT	1500SeIII			1800SeIII			2200SeIII		
		15000/17223			18000/17223			22000/24874		
Injection unit										
Screw diameter	mm	125	135	145	135	145	160	140	160	180
Theoretical shot volume	cc	7915	9232	10651	9232	10651	12969	11238	14678	18576
Shot weight (PS)	g	7124	8309	9586	8309	9586	11672	10114	13210	16719
Shot weight (PS)	oz	252	294	339	294	339	412	357	467	591
Length/diameter ratio	L/D	23.0	21.1	19.7	21.1	19.7	17.8	24.9	22.0	19.5
Injection pressure	MPa	218	187	162	187	162	133	221	169	134
Injection rate	cm ³ /sec	695	810	935	1053	1215	1480	1024	1338	1693
Plasticising capacity (PS)	g/s	117	146	173	189	225	235	144	203	261
Injection stroke	mm	645			645			730		
Max. screw speed	rpm	81			105			89		
Injection unit force	Ton	28.8			28.8			29.0		
Carriage stroke	mm	800			850			1080		
Clamping unit										
Clamping force	Ton	1500			1800			2200		
Max. daylight	mm	2900			3000			3700		
Clamping stroke	mm	1500			1500			1900		
Distance btwn. tie bars	mm	1400x1400			1600x1400			1800x1600		
Min. mould dimension	mm	980x980			1100x980			1260x1100		
Mould thickness range	mm	600~1400			700~1500			900~1800		
Ejector force	Ton	33			33			39		
Ejector stroke	mm	350			380			450		
No. of ejector pins	unit	33			33			33		
Power unit										
Max. motor power	kW	91.6			104.1			132.5		
System pressure	MPa	17			17			17		
Hydraulic pump capacity	L/min	550			715			825		
No. of heating zones	unit	5+1			5+1			5+1		
Heating power	kW	92			92			123		
Total power	kW	184.58			197.08			256.04		
Total current	A	224.4			239.6			311.2		
General										
Machine weight	Ton	100.0			125.0			169.0		
Oil filling capacity	L	2000			2000			2300		

We are always working on improvement and reserve the rights to change design and specifications without prior notice

Machine Dimensions

1500SeIII-2200SeIII

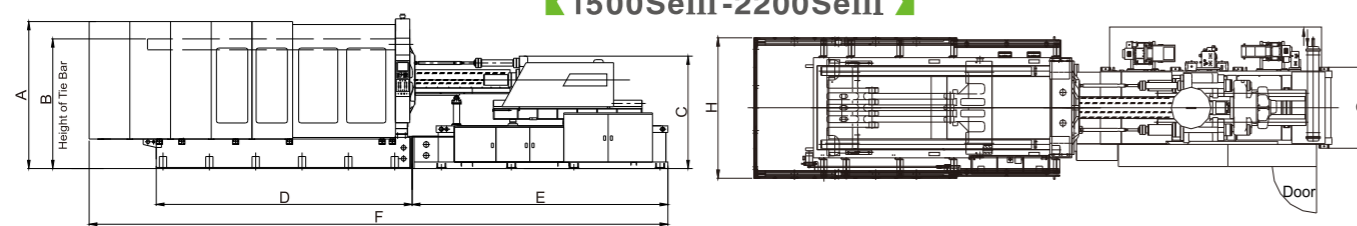

Model	A	B	C	D	E	F	G	H
1500SeIII	2808	2700	3200	6158	5360	13290	1340	2971
1800SeIII	2808	2720	3200	6340	5360	13439	1340	3210
2200SeIII	3267	3240	3580	7675	7298	16724	1555	4085

Remark: C-hopper height for reference only

Platen/Nozzle Dimensions

1500SeIII

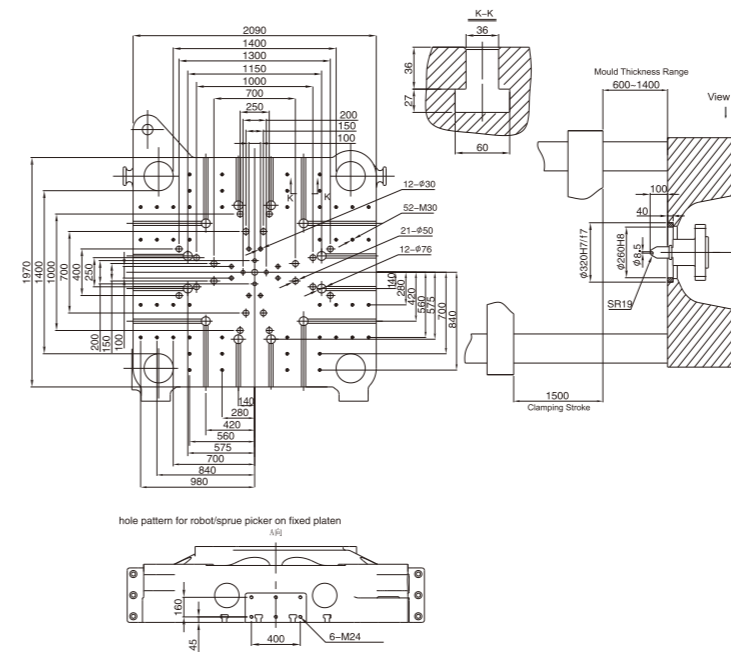

1800SeIII

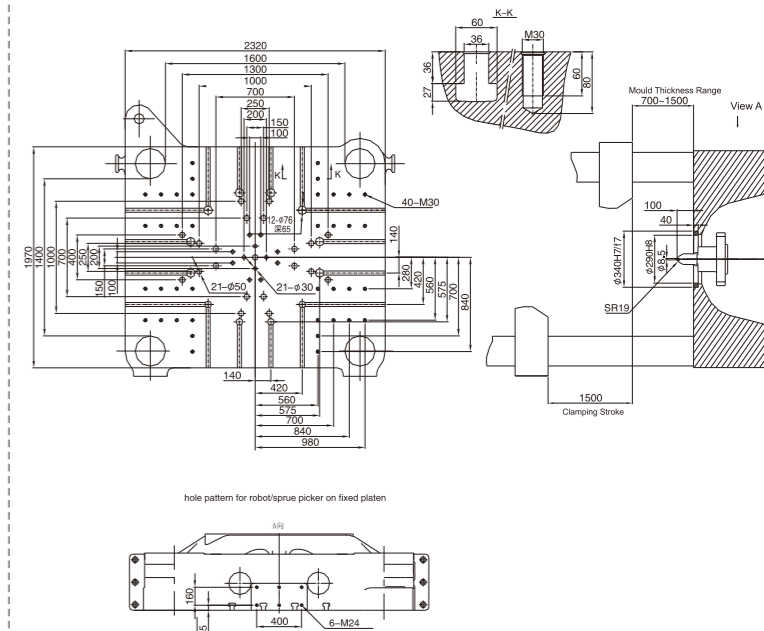

2200SeIII

